



AutoSeal® FD 2200-10

STAND-ALONE PRESSURE SEALING SYSTEM



www.update ltd.com

1-800-229-0009

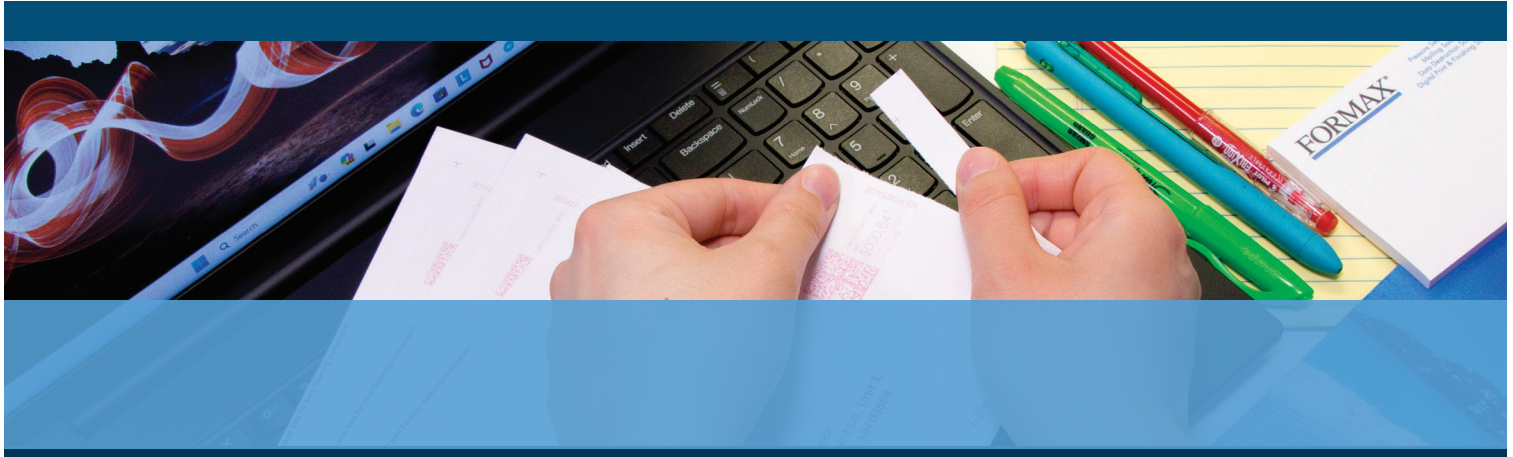

FD 2200-10 shown in-line with folder.

- Stand-alone pressure sealing system
- Integrates easily into floor model folders
- Precision ground clutching 4-roller system
- Three interface connections
- Eight-ball transfer deck

FORMAX®

www.formax.com

Local Dealer:

The **FD 2200-10 Stand-Alone Pressure Sealer** is the ideal solution for high-volume mailers who want to utilize existing floor model folding systems. Purchasing a “sealer-only” system versus a complete folding and sealing solution drastically reduces the up-front cost of adding pressure seal capability. The FD 2200-10 **processes forms at speeds of up to 40,000 per hour**, combined with **heavy-duty construction** built to last in demanding environments. Standard features include a **precision ground clutching four-roller system**, **8-ball transport deck** for a smooth transition from the fold rollers to the sealer, **infrared fault detectors**, **safety interlock**, **mounting bracket**, **plexi-cover**, **static eliminator**, and **heavy-duty casters**.

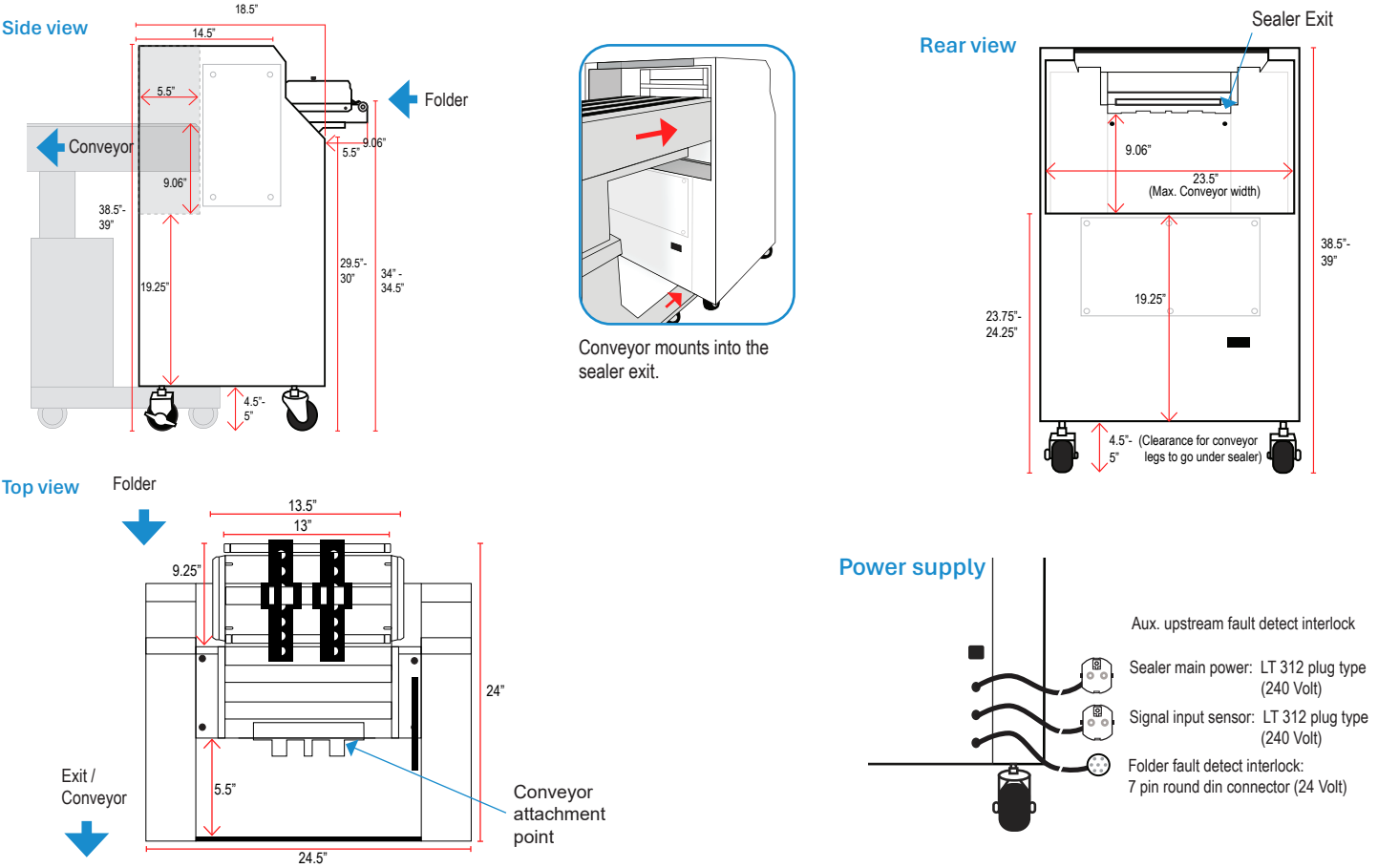

STANDARD FEATURES

- Designed to work with various floor model folders
- Heavy duty construction
- Precision ground clutching four-roller system
- Infrared fault detection
- Clutching rollers reduce belt & motor wear
- Safety cover interlock
- Static eliminator
- Three interface connections
- Hinged plexi-cover
- 10-inch 8-ball enclosed transport deck
- Adjustable height heavy-duty casters
- Mounting bracket for secure attachment to folder

SPECIFICATIONS

Fixed Speed	Up to 40,000 forms/hour
Form Size	Up to 11.5" wide (292mm)
Dimensions	25" W x 24" L x 38.5" - 39" H (63.5 x 61 x 98 - 99cm)
Weight	180 lbs (82kg)
Motor	1/2 HP AC
Power	240V single phase
Power Input Connection	240 Volts
Signal Input Connection	240 Volts to start relay
Fault Detection Connection	24 Volt